

This conversion give you the ability to run shorty or saddle LPo batteries.
 The forward motor position give improved high grip handling.
 The Vari-length centre track rod allows you to find the optimum ackerman position for your car.
 The new raised inboard front camber link ball stud allows for higher adjustments to suit high grip tracks.

NOTE
 Non described fixings are re-used from your kit

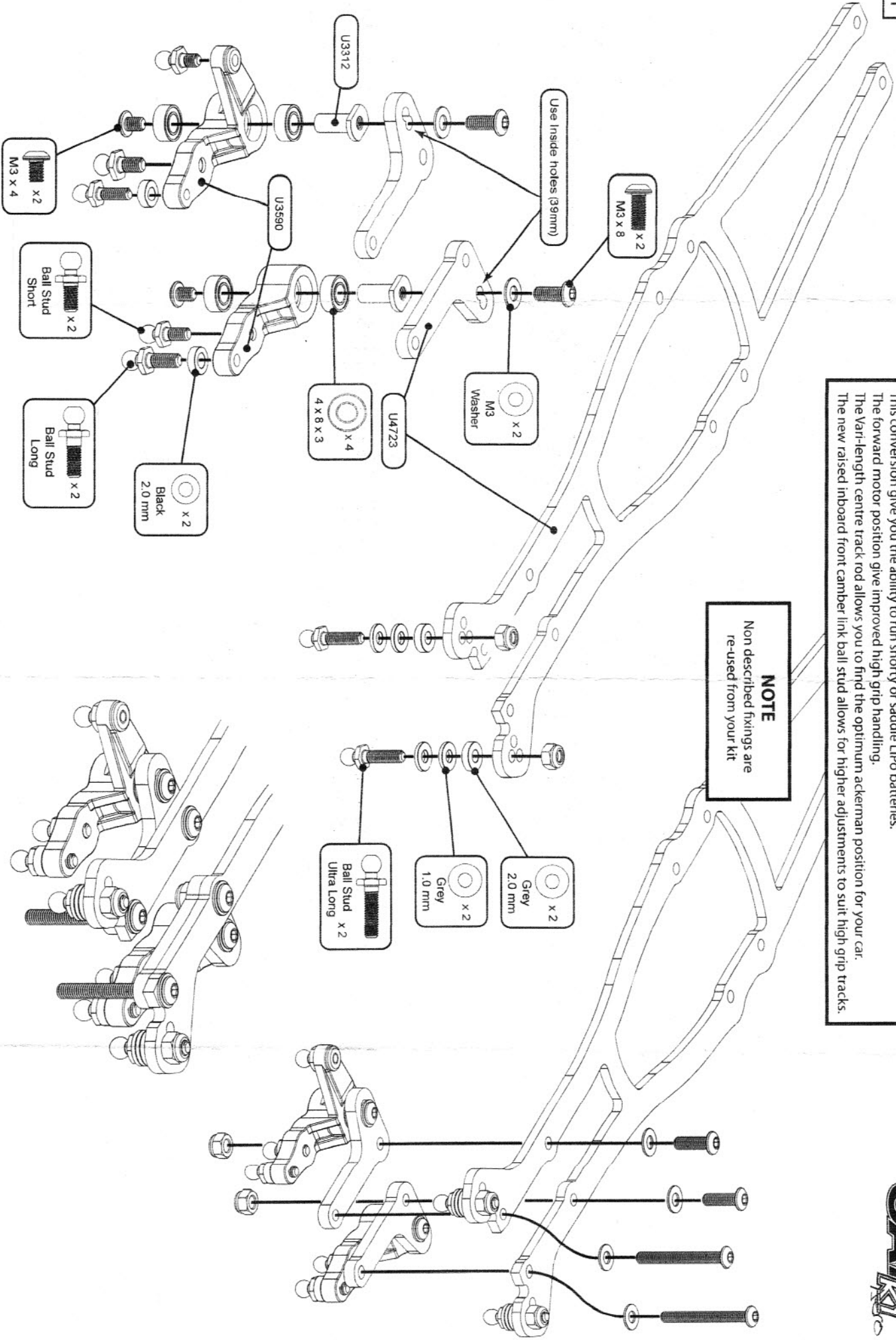

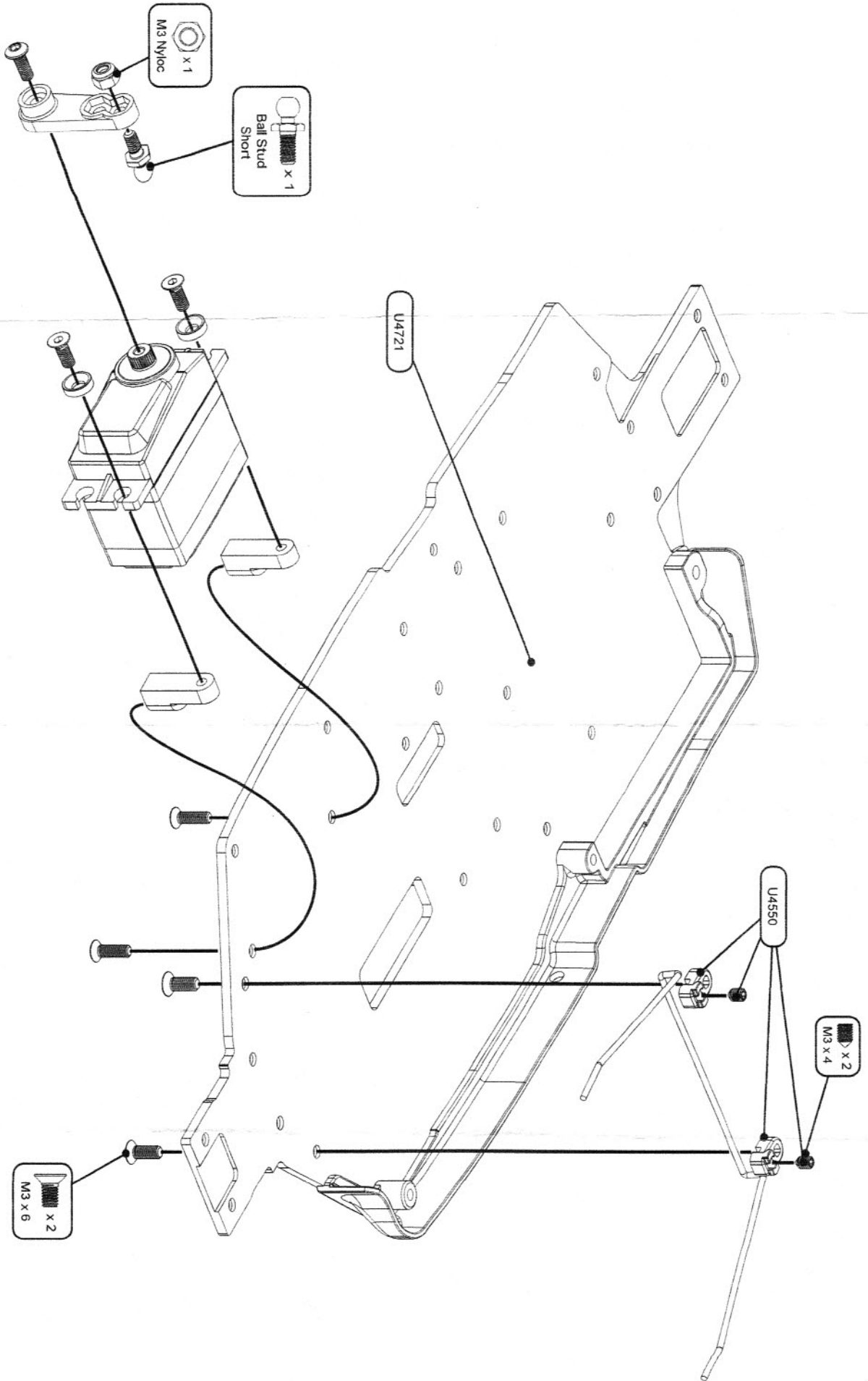

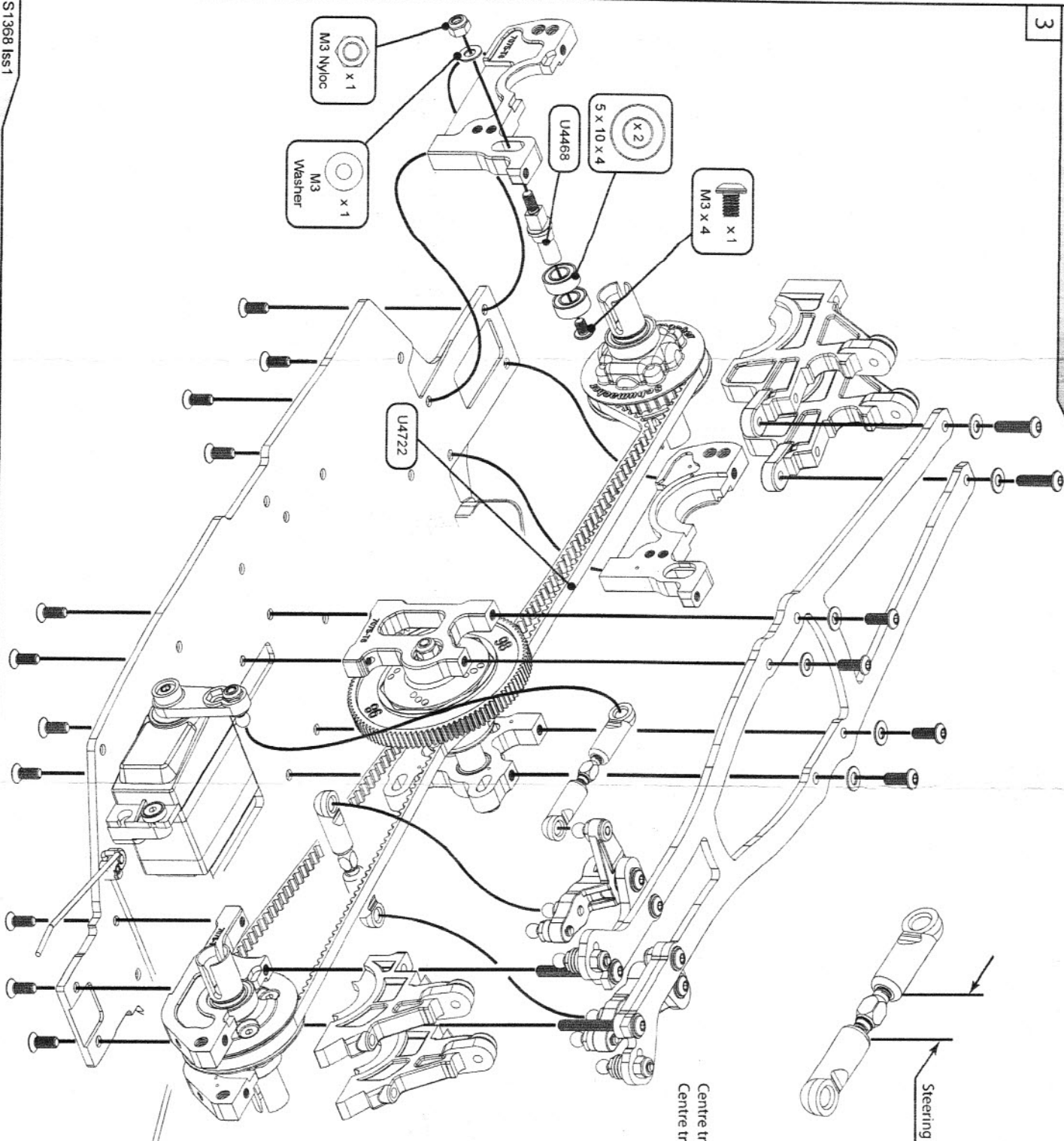

Centre track rod 7.75mm for 39mm Centres using 24mm Turnbuckle
 Centre track rod 12.75mm for 44mm Centres using 30mm Turnbuckle

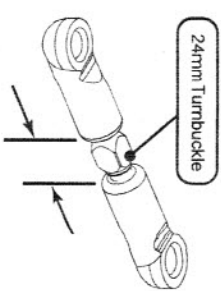

RACERS TIP

Steering Lever Centres.
 When using the 39mm centres you will have the best position for initial steering.

The 44mm Centres gives you the best setting for on power steering.

Ackerman adjustment.
 For improved steering feel and turn in try as below.

Using the 39mm pitch arms and the 24mm Turnbuckle with the centre track rod set to 9.80mm

Using the 44mm pitch arms and the 30mm Turnbuckle with the centre track rod set to 14.80mm



